

# MULTIPOINT INDICATION SYSTEM

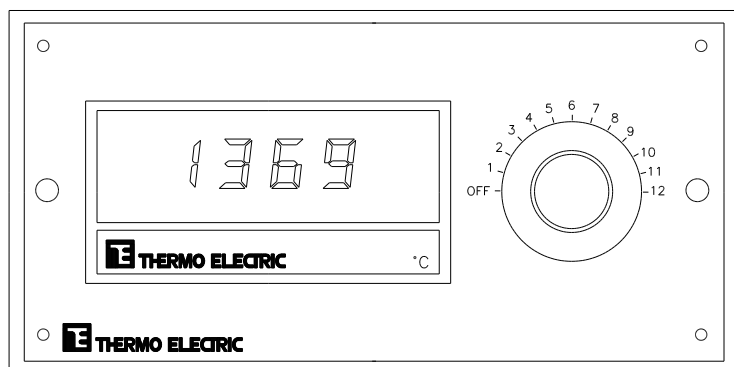

## Features:

- Compact
- Pre-wired internal
- Panel build-in or table use
- Metal case
- Easy to use
- Different type of indicators available
- Fast response

## Specifications:

Model	: SWT-11000 series
Number of points	: 6, 12, 18, 23 standard, other options see overleaf
Type of switch	: 2, 3 or 4 pole, make before break
Contact material	: gold plated, totally enclosed
Contact resistance	: 0,01 Ohms maximum
Contact life	: 25.000 operations minimum
Ambient temperature range	: 0 to +55°C
Contact rating	: 0,75 A at 28 V DC resistive load
Insulation resistance	: 10 Megohm minimum
Internal wiring	: copper, for RTD or thermocouple wiring where applicable
Power supply	: 220 V 50 Hz standard, pre-wired
Connections	: rear mounted terminals; suitable for up to 2,5 mm <sup>2</sup> conductors; panel inserts as option available
Mounting method	: table use or panel mounting via front access panel clamps into DIN size 186 x 92 cutout
Case material	: sheet steel; front panel natural anodised aluminium with black numerals
Dimensions	: DIN size 192 x 96 x 167 mm
Max. depth indicator	: 140 mm behind panel

## Ordering code:

Indicator panel cut-out	: 44 x 92 mm, suitable for IDC-17000, IDC 18000 and many others
Weight	: approx 2,1 kg

SWT	-	110	-	number of points		internal wiring		indicator type		options (wired to rear)
-----	---	-----	---	------------------	--	-----------------	--	----------------	--	-------------------------

# MULTIPOINT INDICATION SYSTEM

## Dimensions (in mm):

06 = 6 points + off  
 12 = 12 points + off  
 18 = 18 points + off  
 23 = 23 points + off

CU = copper 2 wire  
 P3 = copper 3 wire  
 P4 = copper 4 wire  
 x = thermocouple  
 extension wiring  
 where applicable

IDC-18000 see J/201  
 IDC-17000 see J/205

A - one alarm  
 AA - two alarms  
 AAA - three alarms  
 RS - RS232  
 SP - special (specify)

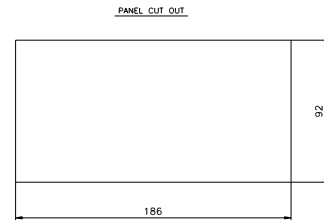
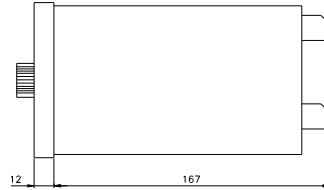
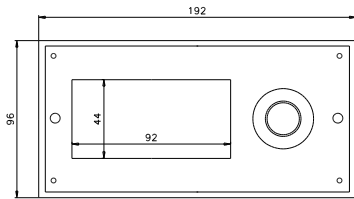

## Specials:

- Miniature panel inserts for thermocouple inputs at rear.
- Standard panel inserts for thermocouple inputs.
- NOTE: 12, 18 and 23 points will have in that case a larger size housing (288 x 96 mm).
- 2,5 meter power cord with plug.
- 6 or 12 miniature panel inserts at front.
- 3HE high 19" rack mounting plate.
- 3HE high 19" rack mounting plate with 2 panel cutout for SWT-11000.
- Power on/off switch at rear or at front.
- 24 points without off.
- Other number of points, up to 24 points maximum.

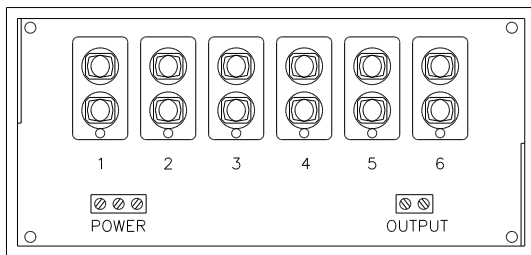

Rear panel of a SWT-11006...x-Indicator-special with a 6 standard jack inserts in correct calibration. Power connection (L, N, earth) with screw terminals, output, screw terminals.