

WELD-IN TYPE TEMP SENSORS

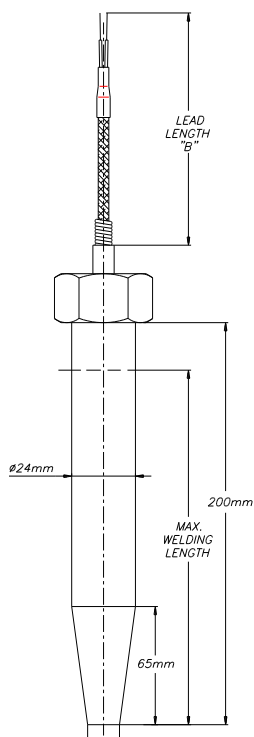
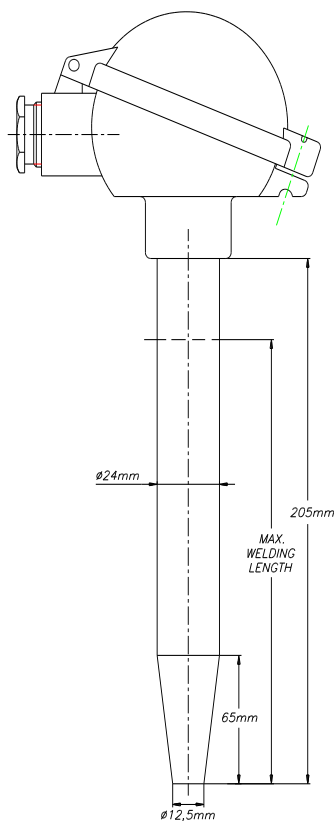

Specifications:

with bar stock thermowell

Type	:	single thermocouple or Pt100	
Connection head	:	replaceable spring loaded insert cast aluminium with swing cover;	with
Thermocouple type	:	chromel-alumel, type J insulated junction chromel-alumel, type K insulated junction Standard limits of error	con
Resistance type and tolerances	:	SI MC 96.1 / IEC-584	chr
Thermowell	:	Pt100, IEC-751 class B, 3-wire system drilled bar stock	AN
Thermowell material	:	13 CrMo 4 4 (Wstnr.1.7335) CrMo 9 10 (Wstnr.1.7380) CrNiNb 16 13 (Wstnr.1.4961)	10 X8
Max. welding length	:	175 mm is maximum length from tip of the thermowell to the welded joint; the welding length has to be selected, such that only the conical tip will be immersed	repl
Approval	:	Bureau Veritas	
Ordering code			Sensor type
OTP-15023-J- <input type="checkbox"/> mm			iron-constantan, type J
OTP-15023-K- <input type="checkbox"/> mm			chromel-alumel, type K
OTP-15027-Pt100- <input type="checkbox"/> mm			Pt100

Specifications:

Type	:	single thermocouple or Pt100
Thermocouple type	:	iron-constantan, type J insulated junction chromel-alumel, type K insulated junction
Standard limits of error	:	ANSI MC 96.1 / IEC-584
Resistance type and tolerances	:	Pt100, IEC-751 class B, 3-wire system
Thermowell	:	drilled bar stock
Thermowell material	:	13 CrMo 4 4 (Wstnr.1.7335)
Max. welding length	:	175 mm is maximum length from tip of the thermowell to the welded joint; the welding length has to be selected, such that only the conical tip will be immersed
Lead wire	:	teflon/kapton insulated flexible wire with stainless steel braiding (type TFHF/TWS)
Lead wire length 'B'	:	to be specified; replace box in ordering code with required length; our standard lengths are 3000 mm, 5000 mm and 7000 mm
Approval	:	Bureau Veritas
Ordering code		
OTP-15011-J- <input type="checkbox"/> mm		
OTP-15011-K- <input type="checkbox"/> mm		

OTP

Pt100